

5749_PANTALLA SOPORTE WANTOL

FRONT PART

5749_Pantalla Soporte Wantol Manual de instrucciones (Esp)



Recomendamos que lea detenidamente este manual de instrucciones y lo conserve para futuras consultas.

1. Descargue e instale una aplicación HUD adecuada desde Google Playstore (Android) o APP Store (iOS). Para mayor eficiencia, pruebe con estas opciones de búsqueda:
 - "HUD Navigation"
 - "GPS HUD"
 - "Head up Display"

2. Retire el film protector de la pantalla reflectante.

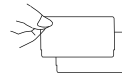

3. Retire el film protector de la base antideslizante de la pantalla soporte.

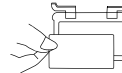

4. Introduzca la pantalla en las ranuras del soporte.

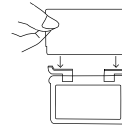

5. Coloque la almohadilla antideslizante incluida en el salpicadero.

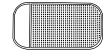

6. Coloque la pantalla soporte en la almohadilla antideslizante.

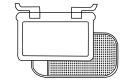

7. Coloque su dispositivo en la base antideslizante de la pantalla soporte.

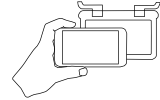

8. Ajuste la pantalla reflectante para obtener un ángulo de visión óptimo.



BACK PART

5749_Dashboard Holder User manual (Eng)



It is recommended to read this user manual carefully and keep it for future reference.

1. Download and install an appropriate HUD application from Google Playstore (Android) or APP Store (iOS). To be more productive try these keywords for searching:
 - "HUD Navigation"
 - "GPS HUD"
 - "Head up Display"

2. Remove protective film from reflective screen.

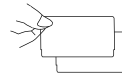

3. Remove protective film from the non-slip mat on the HUD mount.

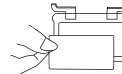

4. Slide the screen into slots on the HUD mount.

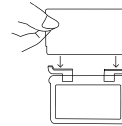

5. Place included non-slip grip pad on the dashboard.

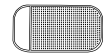

6. Place the HUD mount on the non-slip grip pad.

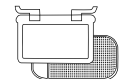

7. Place your smartphone on the HUD mount's non-slip mat.

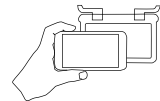

8. Adjust the reflective screen to your best viewing angle.

